

# JRS CUSTOM FABRICATION

186 NW 68th Avenue

Ocala, FL

(352) 351-2100

## GENERATOR ENCLOSURE LARGE MISSILE IMPACT TEST

**NOTES:**

1. THE COMPONENTS INDICATED IN THESE DRAWINGS HAVE BEEN RESISTANCE TESTED FOR IMPACT PER MODIFIED STANDARDS SUPPLIED BY THE DEPARTMENT OF EMERGENCY MANAGEMENT AND THE DEPARTMENT OF EDUCATION. SEE IMPACT TEST REPORT CONDUCTED MAY 2007.

2. THESE DRAWINGS INDICATE ONE SIZE GENERATOR ENCLOSURE. OTHER SIZES COMPOSED OF THE SAME TESTED COMPONENTS ARE ACCEPTABLE.

3. THE WINDLOAD CAPACITY AND RESISTANCE OF THE GENERATOR ENCLOSURE WAS NOT TESTED AND IS NOT DISCUSSED IN THIS SUBMITTAL.

### INDEX OF DRAWINGS

COVER SHEET

ASSEMBLY VIEW

SA ENCL LVL II

ROOF ASSEMBLY

ENC. FRAME

ENC. SKIN

48x72 BLANK DOOR

# JULY, 2007

Douglas R. Barkley, M.S., P.E.  
F.P.E. # 49090

**Barkley**  
CONSULTING ENGINEERS, INC.  
*Structural & Civil Engineers*  
2804 REMINGTON GREEN CIRCLE, SUITE 1  
TALLAHASSEE, FLORIDA 32308  
OFFICE 850-297-0440  
FAX 850-297-0697

DBA REDUCTION  
25DBA RED @ 7M

TYPE  
**ASSEMBLY VIEW**

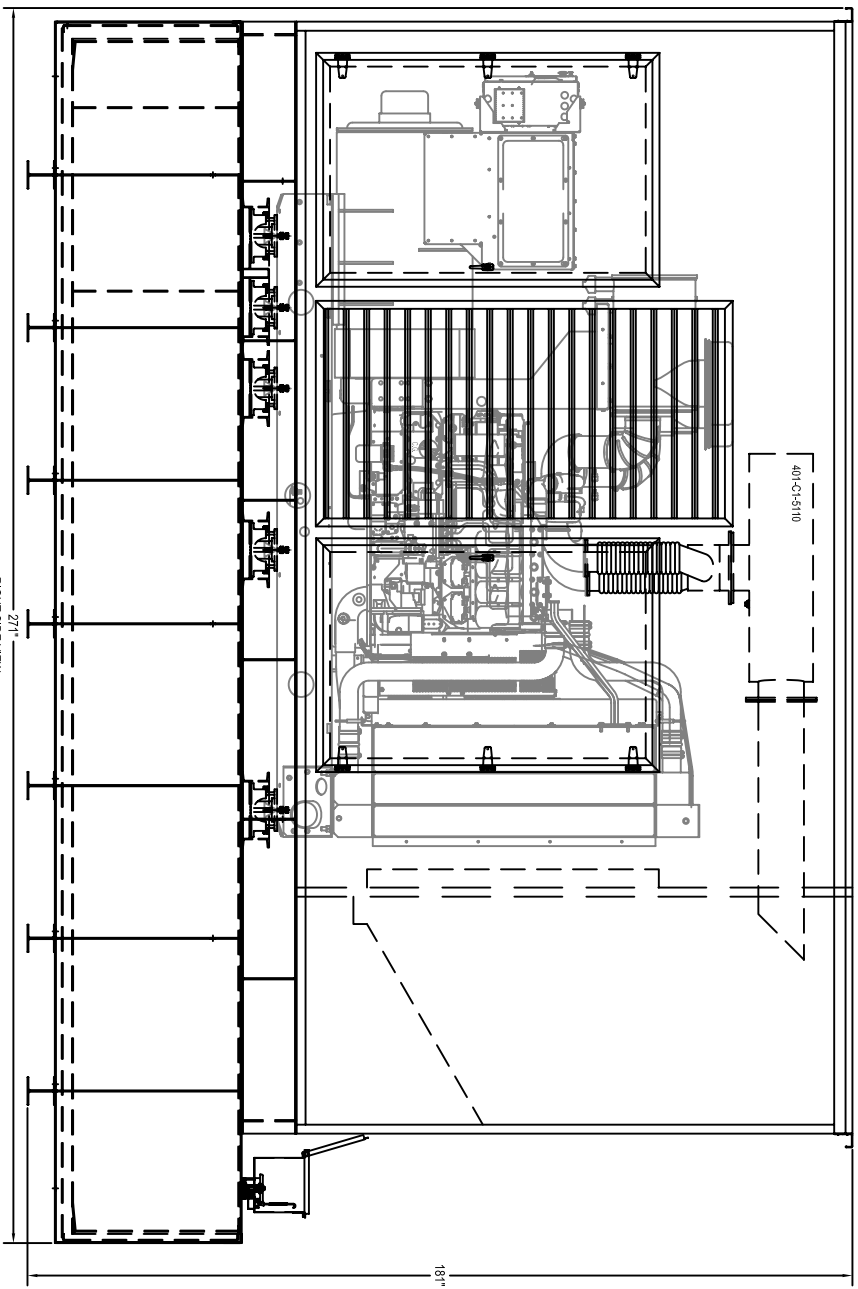
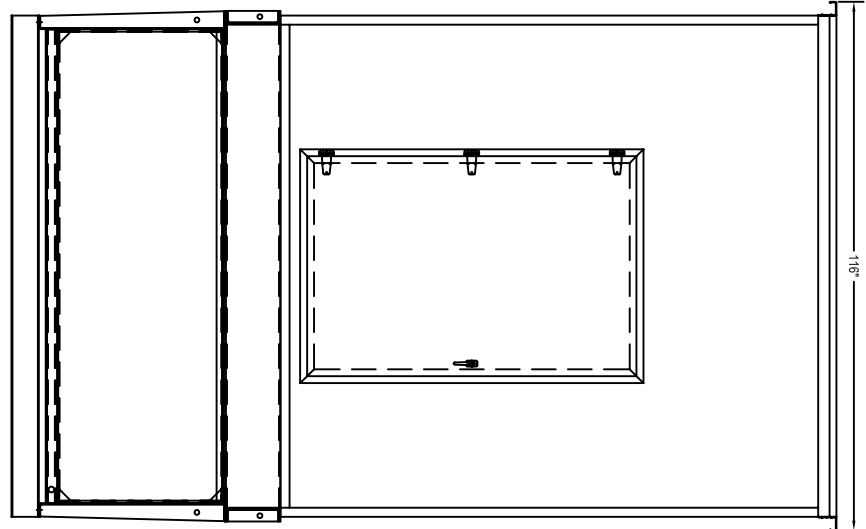

SPECIAL INSTRUCTIONS

- 1 MOUNT UNIT & COMPLETE PACKAGE
- 2 PROVIDE & INSTALL EXHAUST MOUNTING KIT
- 3 2" TUBE CONSTRUCTION
- 4 PROVIDE AND INSTALL BATTERY RACK
- 5 INSTALL CUSTOMER SUPPLIED BATTERY CHARGER
- 6 5 YEAR ENCLOSURE WARRANTY
- 7 MISSILE IMPACT RESISTANT ENCLOSURE (CERTIFIED BY DOE / DMS TESTING)
- 8 150 MPH WIND LOAD RATED (CERTIFIED BY JRS / EBS)
- 9 MISSILE IMPACT RESISTANT INTAKE LOUVERS
- 10 ENCLOSURE SKIN IS MATERIAL IS 0.08 THICKNESS

**JRS Custom Fab.**  
OCALA, FLORIDA  
PHONE(352) 351-2100 FAX(352) 351-5881

DRAWN BY: M.M. DATE: 07/1/07 SCALE: N.T.S. SPEC: ALUMINUM

REV

DBA REDUCTION  
25DBA RED @ 7M

TYPE  
**SA ENCL LVL II**

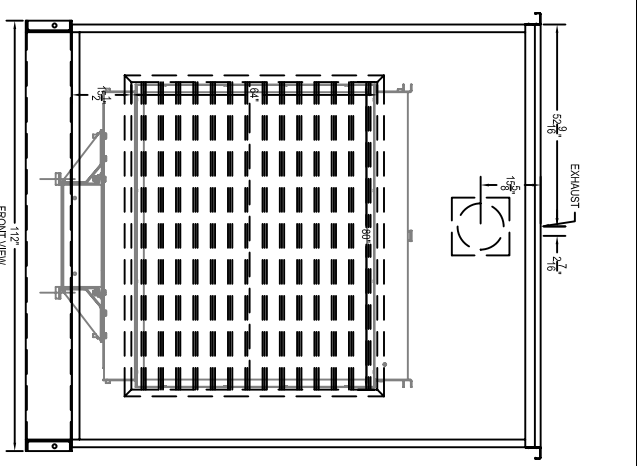
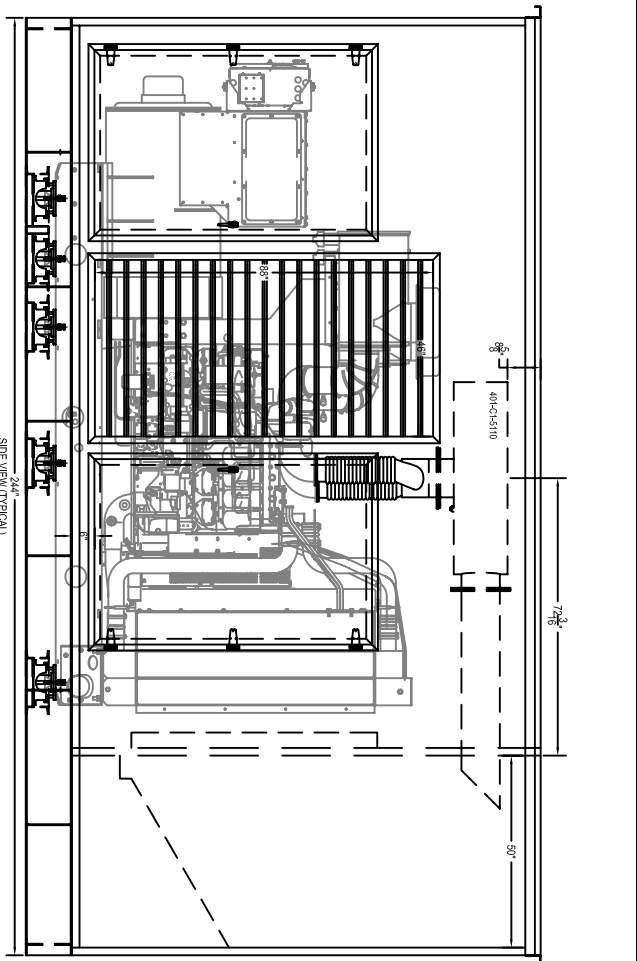
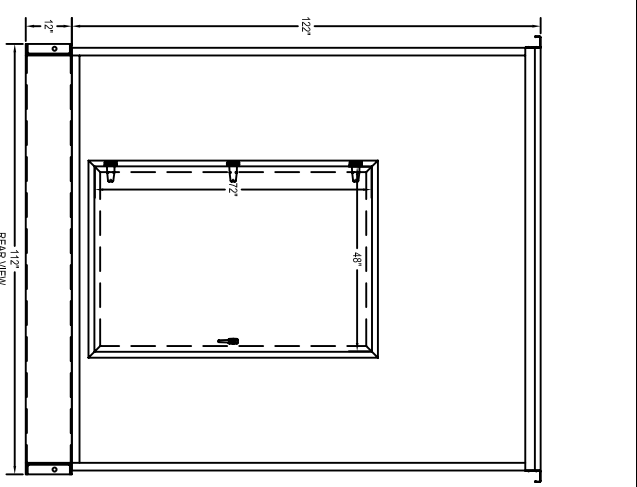

APPROVAL CHECKLIST

REVIEWED BY	DATE	
APPROVED AS NOTED	CONTROL PANEL LOCATION	CIRCUIT BREAKER LOCATION
NO EXCEPTIONS TAKEN / RELEASE FOR PRODUCTION	RIGHT SIDE	RIGHT SIDE
	LEFT SIDE	LEFT SIDE
NOT APPROVED / REVISE AND SUBMIT	REAR	REAR

\*\*\*APPROVAL CHECKLIST MUST BE SIGNED PRIOR TO PRODUCTION\*\*\*

EXHAUST LIST

QTY.	PART	PART NUMBER
1	10" SILENCER	401-C1-S110
2	NUT, BOLT, GASKET KIT	47-GF-1000
2	NUT, BOLT, GASKET KIT FOR 6" CUMMINS FLANGE	47-CUM-800-GF
1	STRAIGHT TUBE 45° CUT FLANGED OE	25-1000, B=57"
1	6" CUMMINS X 6" CUMMINS X 10" ANSI WYE FLEX 32" OAL	13-33735

SPECIAL INSTRUCTIONS

- 1 MOUNT UNIT & COMPLETE PACKAGE
- 2 PROVIDE & INSTALL EXHAUST MOUNTING KIT
- 3 2" TUBE CONSTRUCTION
- 4 PROVIDE AND INSTALL BATTERY RACK
- 5 INSTALL CUSTOMER SUPPLIED BATTERY CHARGER
- 6 5 YEAR ENCLOSURE WARRANTY
- 7 MISSILE IMPACT RESISTANT ENCLOSURE (CERTIFIED BY DOE / DMS TESTING)
- 8 150 MPH WIND LOAD RATED (CERTIFIED BY JRS / EBS)
- 9 MISSILE IMPACT RESISTANT INTAKE LOUVERS
- 10 ENCLOSURE SKIN IS MATERIAL IS 0.08 THICKNESS

**JRS Custom Fab.**  
OCALA, FLORIDA  
PHONE(352) 351-2100 FAX(352) 351-5881

DRAWN BY:	M.M.	DATE	07/11/07	SCALE	N.T.S.	SPEC	ALUMINUM	UNIT	REV
-----------	------	------	----------	-------	--------	------	----------	------	-----

QUANTITY	MATERIAL	MODEL/GAL	CUSTOMER	WO#
1	.090 ALUMINUM	ROOF ASSEMBLY		

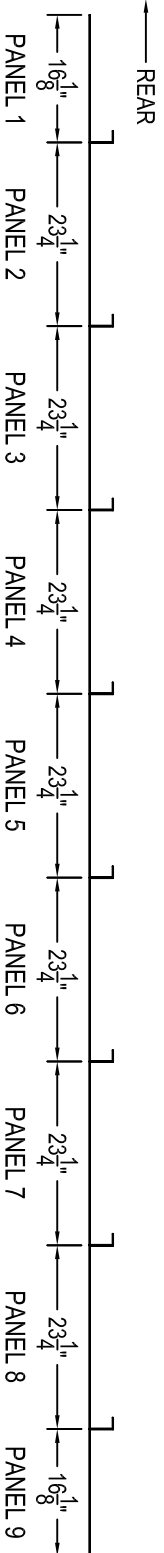
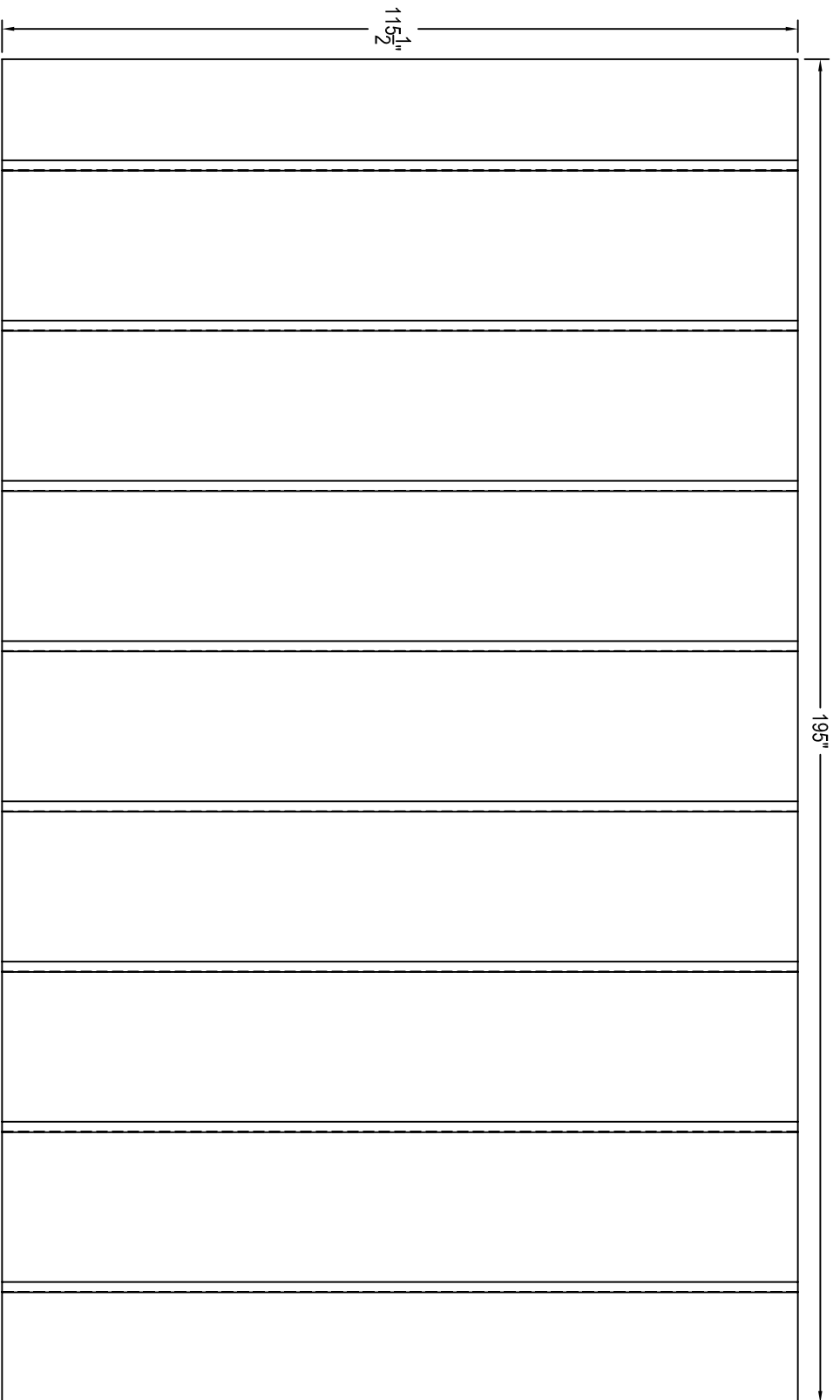

SPECIAL INSTRUCTIONS

DRAWN BY:	M.M.	DATE:	07/1/107	SCALE:	N.T.S.	DESC.:	ROOF ASSEMBLY
<b>JRS Custom Fab.</b> Ocala, Florida Phone(352) 351-2100 FAX(352) 351-5881						REV:	



MATERIAL	ALUMINUM ENCLOSURE	QUANTITY	1
----------	--------------------	----------	---

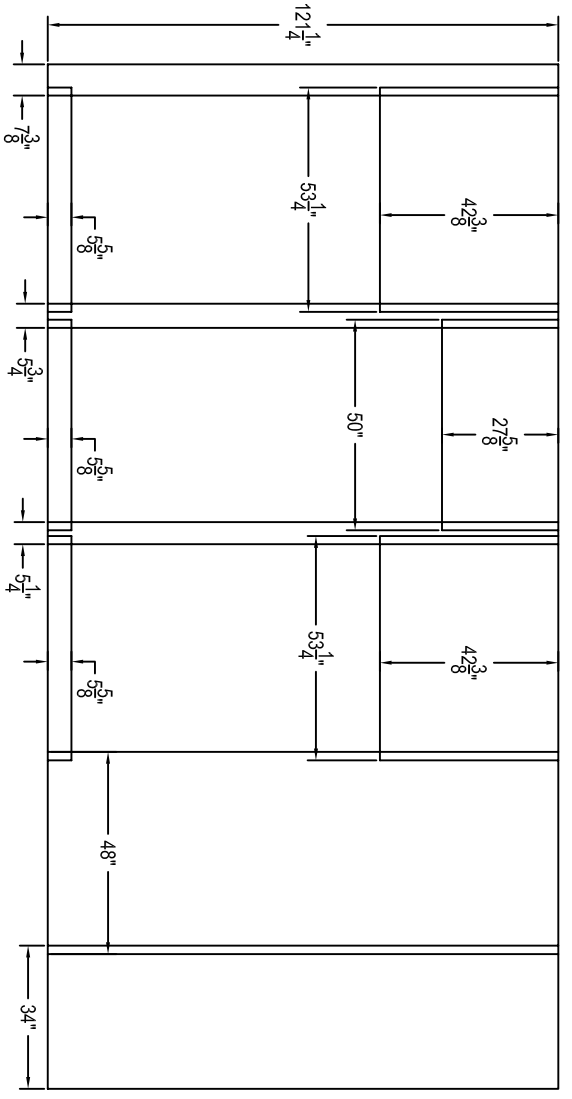
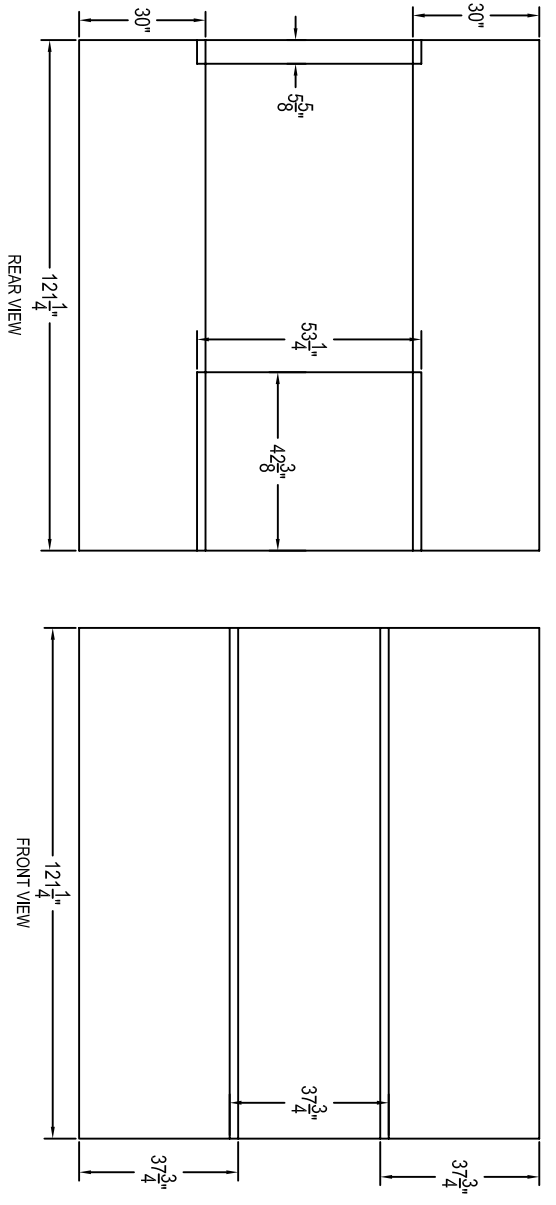

0.09 ALUMINUM SHEET	
QUANTITY	DIMENSIONS"
2	121-1/4 X 48
3	121-1/4 X 37-3/4
2	121-1/4 X 34
2	121-1/4 X 30
2	121-1/4 X 7-3/8
2	121-1/4 X 5-3/4
2	121-1/4 X 5-1/4
5	53-1/4 X 42-3/8
5	53-1/4 X 5-5/8
2	50 X 27-5/8
2	50 X 5-5/8
5-D	47-1/4 X 71-1/4

**JRS Custom Fab.**  
 OCALA, FLORIDA  
 PHONE(352) 351-2100 FAX(352) 351-5881

DRAWN BY: D.J.	DATE 07/11/07	SCALE N.T.S.	FILE #	DESC. ENC. SKIN	REV
----------------	---------------	--------------	--------	-----------------	-----

